



## Club, Suite, & Musa, Quick Start Guide

This is a simple guide to get your Wittus pellet stove set up and running. Please read your owners manual and refer to the manual for more detailed instructions.

We suggest you have your pellet stove installed by a licensed contractor. If you choose to do your own installation, carefully follow the installation instructions in your manual as well as the instructions specific to the brand of pellet venting system you use.

### Getting Started

1. Check that your stove has been installed properly and that the fire box and ash pan have been cleared of manuals, tools, etc. Make sure that all combustible materials are a safe distance from the stove.
2. Connect the power cord to the rear of the stove with the toggle switch in the off position.
3. Plug the power cord into a surge protector that is connected to a properly grounded outlet.
4. Switch the toggle switch on the back of the stove to the on position. (This switch should be in the off position if the stove is not in use for an extended period of time.)

### Remote Control and Emergency panel

The functions of your stove are controlled by the remote control. In case of emergency, the stove can be operated by the small emergency panel.

The remote control allows you to adjust all of the operating parameters, of the stove. The stove heat output, fan speeds, programmable timer, and room temperature are all controlled by the remote.

The temperature sensor is built right into the remote control. This allows more precise measurement of the temperature in the room to be heated without the inconvenience and limitations of wired thermostats.

The remote control has bright back-lighting which is activated by simply pressing any key.

Diagrams of the remote and the emergency panel are included in this quick start guide. Please consult the owner's manual for more detailed information.

### Time & Date Set Up

- 1. There are 4 buttons on the remote. Starting from the top they are 3,4,5, & 6.**
2. Simultaneously press buttons **4** and **6** of the remote control **for 3 seconds** with the stove on to access the menu for setting current day and time.
3. When the message "**CLOCK**" appears use button **5** to select the current hour and day of the week and confirm it with button **6**.
4. Next set the minutes and confirm them with button **6** and then the day. Upon completion, press key **6** to confirm and exit the menu.

**NOTE if no button is pressed for 7 seconds the board will go back to menu and your settings will not be saved.**

### Setting thermostat reading from Celsius to Fahrenheit

**With the stove off**, press button **4 for at least 5 seconds** to select the unit of temperature measurement, either Celsius (**°C**) or Fahrenheit (**°F**).

**Lock & Unlock – to lock or unlock the remote hold button 6 for 3 seconds**

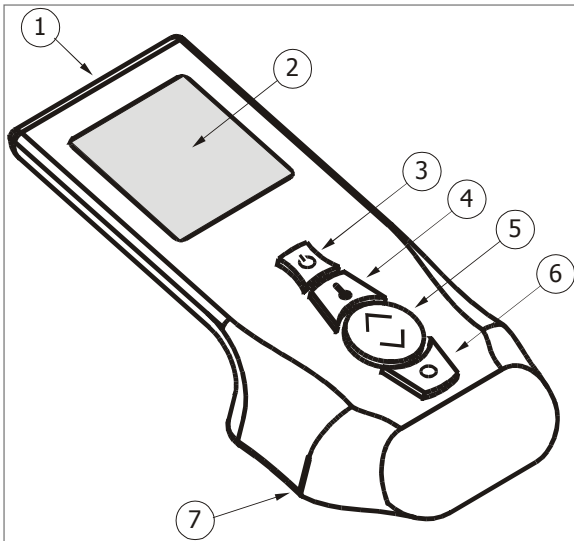

### KEY on the Remote Control

1. Location of the room temperature sensor.
2. Back-lit LCD.
3. On/off button. By pressing this button in combination with others, you can access other menus such as the one for setting the current time.
4. Button to select operating mode (MANUAL – AUTOMATIC – AUTOMATIC WITH ECO-STOP). This button in combination with others allows access to other menus such as the menu to set the current time or to customise the timer.
5. Button to adjust stove output level and fan speed, and any other adjustment.
6. The MENU button to access the menus for air distribution, SLEEP mode and TIMER.
7. Support base & Battery compartment.

### Diagram of the LCD display panel showing all the possible icons

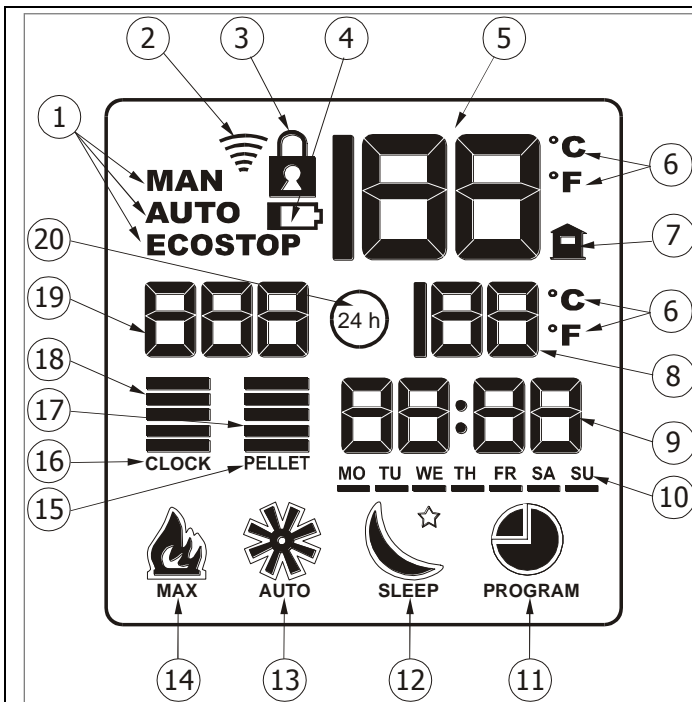

### KEY

1. Icons that indicate the operating mode of the stove (MANUAL–AUTOMATIC– AUTOMATIC WITH ECO STOP).
2. Icon for data transmission to stove.
3. This icon, if on, indicates that the keyboard is locked (provided to prevent accidentally pressing keys).
4. If this icon is on steady it means that the batteries need to be replaced.
5. This icon shows the temperature in the room where the remote control is, measured by a sensor inside the remote control.
6. Unit of measure selected to display set/measured temperature (degrees Celsius – Fahrenheit).
7. This icon appears with the room temperature measured by the sensor in the remote control.
8. Temperature set by the user, which is to be reached in AUTOMATIC mode. In MANUAL mode this signal will be off.
9. Internal clock. It can temporarily be used to provide a countdown if the SLEEP function is active.
10. Icons that indicate the current day (in English). When setting the personalized TIMER, the bars underneath, if on, indicate that for that day time programs have been activated.
11. Icon that indicates the TIMER function. If completely off, the TIMER is deactivated. If only the border of the icon is on, the TIMER is active. If the icon is completely on, it indicates the stove is in the TIMER setting mode.
12. Icon that indicates the SLEEP function. If completely off, SLEEP is deactivated. If only the border of the icon is on, SLEEP is active, meaning that the stove will shut off at the end of a countdown set by the user and visible in icon no. 9. If the icon is completely on, it indicates SLEEP setting mode.
13. Icon for the speed of the fan. If the message AUTO is on, it means that the fan speed is set to adjust automatically.
14. Icon of the flame that shows the adjustment of the flame from one of five power levels. If the flame is at power setting 5, the message MAX will also appear.
15. This icon, if active, indicates that it is possible to adjust the feed rate of the pellets (specialized technician only).
16. This icon, if active, indicates that it is possible to adjust the time that appears in icon no. 9.
17. These bars indicate the ventilation power: 1 bar = 1st speed; two bars = 2nd speed;...five bars = 5th speed.
18. These bars indicate the flame power: 1 bar = 1st power; two bars = 2nd power;...five bars = 5th power. These bars appear only if the stove is in MANUAL operation mode.
19. This icon is used for the selection of the weekly program when setting the TIMER. It is also used to select the daily programs in the personalized timer program.
20. When setting the TIMER, if this icon is on together with no. 19, it indicates that you are choosing a personalized weekly program (which requires the insertion of daily time periods -> 24h).

## Diagram of the Emergency Panel

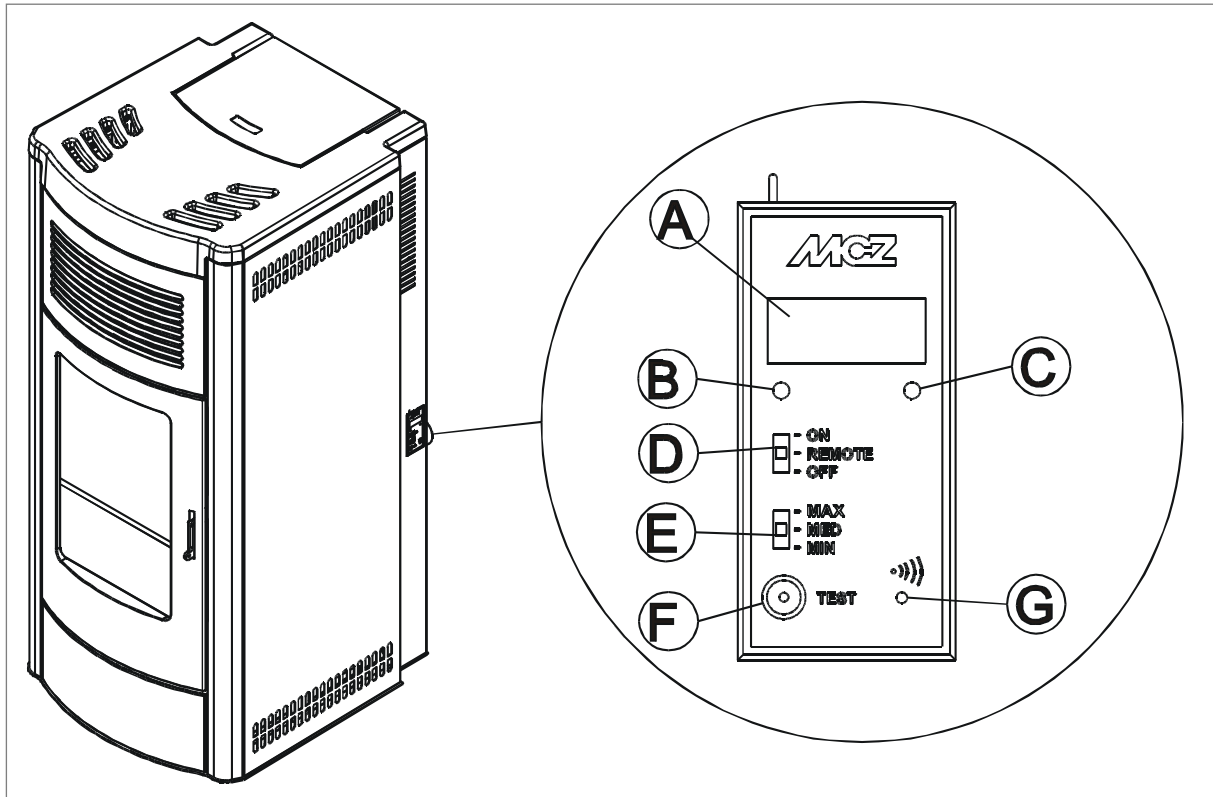

### KEY

- A. Three figure display which indicates a series of information about the stove, as well as the identification code for any operating anomaly.
- B. **GREEN** LED to indicate:
- OFF = Stove off
  - FLASHING = Stove in lighting phase
  - ON STEADY = Stove on
- C. **RED** LED to indicate:
- OFF = Stove on
  - FLASHING SLOWLY = Stove shutting down
  - FLASHING RAPIDLY = Stove in alarm status (accompanied for 10 minutes by a beep)
  - ON STEADY = Stove off

- D. Three-position selector for function

- OFF = Stove shut off manually in absence of remote control
- REMOTE = Stove can be controlled **only** by remote control
- ON = Stove turned on manually in absence of remote control

- E. Three-position selector for selection of power

- MIN = Selector to run the stove at minimum power with no remote control and with selector **4** in ON position
- MED = Selector to run the stove at medium power with no remote control and with selector in ON position
- MAX = Selector to run the stove at maximum power with no remote control and with selector in ON position

- F. Push button for diagnostics of stove operating status.

- G. button to connect the stove to a new remote control (by means of a procedure explained below).

### Start-Up

Upon first start-up of the product, it may be necessary to re-sync the remote control.

- Connect the stove to the socket and switch the power supply button on.
- Ensure that the selector **D** of the emergency panel is in the position **REMOTE**.
- When the first text appears onto the display of the emergency panel, press the embedded button **G** with the aid of a pointy object (toothpick).
- Three flashing lines "- - -" will appear on the display. Press the on/off button of the remote control for confirmation. You will hear a beep.

## First fire

1. The first fire is designed to be a slow break in fire that will cure the paint on your stove. This fire should be performed at a time that you can have the windows open as there will be some smoke and odor (from the curing paint) for the first few hours.
2. The first fire should be in the manual mode at the #3 power level. It is not recommended to run the stove on high for the first fire.
3. Press button 4 and select manual mode.
4. Press button 5 to set the output level to 3.
5. At this point the stove should start feeding pellets and ignite the fire, because the stove is new and there are no pellets in the auger it may be necessary to press the start button a second time.
6. If pellets are feeding but the fire fails to ignite remove the pellets from the burn pot and make sure the burn pot is properly seated, go through the ignition cycle again.

## Manual & Automatic settings

Your stove can be run in 3 different modes: Manual, Auto, and Program mode.

**Manual mode** will give you a constant heat output with settings options between 1 & 5. You can also set the speed of the fan as desired from 1 to 5. To select manual mode:

1. Press button 4 on the remote and select Manual. The Manual icon will appear in the upper left side of the screen.
2. Press button 5 to set the desired output.
3. Press button 6 and the fan icon will be highlighted.
4. Press button 5 to adjust the fan speed between 1 & 5. You can also select A (Auto) and the fan will run at the same level as the stove.

**Automatic mode** will allow you to set the desired temperature in the room on the on board thermostat. The stove will ramp up to high until the room temperature reaches the desired level. The stove will then ramp down to low and stay on to maintain the desired temperature, turning it's self up and down as needed.

1. Press button 4 and select auto. The Auto icon will appear in the upper left.
2. Press button 5 to set your desired temperature.
3. Press button 6 and the fan icon will be highlighted.
4. Press button 5 to adjust the fan speed between 1 & 5. You can also select A (auto) and the fan will run at the same level as the stove.

**ECO – Stop** is an optional Auto mode that will turn the stove off if the room temperature remains constant or above the set level for 20 minutes. The stove will re-light automatically if the thermostat later calls for heat.

1. Press and hold button 4 for 5 seconds to activate or de-activate ECO-stop.

**Program Mode** allows you to set the temperature as well as the days and times you desire heat. Your stove comes with 60 pre-set programs for easy set-up or you may choose to enter your own customized program. To set up the program mode please consult your owner's manual.