

Tested and listed by:



Portland  
Oregon, USA

OMNI-Test Laboratories, Inc.

- Read this manual carefully and save the instructions -

## Installation and user manual

Trendline 1+2+3  
Troja 1+2+3  
Softline  
Fineline 1+2  
Zeus  
Athene  
Hera  
Avanti  
Cubic 109-166-215  
Cubic Corner  
Cubic Wall  
Cubic W200  
Cosmo Models

Manufactured by:



Ahornsvinget 3-7 . DK-7500 Holstebro  
T.++45 96101200 F.++45 97425216 . [www.jydepejsen.com](http://www.jydepejsen.com)

Imported by:



FIRE BY DESIGN

PO Box 120 . Pound Ridge NY  
T.914-764-5679 . F.914-764-0465 . [www.wittus.com](http://www.wittus.com)



Jydepejsen A/S - version 5 - 04/09

## Contents:

	Page:
1. Wood-burning stoves from Jydepejsen A/S	3
2. Before installing your stove	4
3. Chimney	8
4. Chimney connector	8
5. Heat generation and distribution	11
6. Sensible wood burning	12
7. Technical information on wood burning	12
8. Air supply and combustion	14
9. Preparation for the first fire	16
10. Lighting the stove	16
11. Refueling	16
12. Troubleshooting	17
13. Maintenance of the stove	18
14. Warranty	22
15. Spare parts list	22

## 1. Wood-burning stoves from Jydepejsen A/S

A wood burning stove from Jydepejsen A/S is a quality Danish product. Our stoves have been providing a cheerful, cozy atmosphere and excellent savings on heating in many homes since the company was founded in 1979.

We continue to produce stoves that are among the best on the market. The key factors are simple operation, optimum combustion, timeless design and environmental awareness.

From the start we created innovations that have since become the norm for quality European stoves. In many respects these pioneering ideas have helped Denmark maintain its position as Europe's leading producer of wood burning steel stoves. In the production, research & development we work purposefully towards reducing environmental impact. It is also important to us that our stoves achieve environmentally friendly combustion, which is ensured by Jydepejsen's long-standing design principles.

All the products in this manual have been rated to 81 % efficiency.

To realize our mission of environment friendly combustion, it is your responsibility as a consumer to use the correct fuel and operate your stove according to the instructions.

The aim of this manual is to guide and instruct stove owners in proper burning, and to minimize the risk of incorrect operation of the stove.

Failure to follow instructions may result in property damage, bodily injury, or even death. It is therefore very important to read this manual carefully, and save the instructions.

Correct operation is also vital with regard to our applicable warranty terms.

For more information on wood burning visit the website <http://woodheat.org/>.



Take particular note of this symbol:  
This indicates special attention.

Kind regards  
All at Jydepejsen A/S

## 2. Before installing your stove

Jydepejsen stoves Cosmo, Cubic, Trend-line1+2+3, Troja 1+2+3, Soft-line, Fine-line, Zeus, Athene, Hera and Avanti are tested by OMNI-Test Laboratories, Inc. of Beaverton, Oregon and are listed to UL 1482 and ULC S627. They are also EPA certified and meet the more stringent WA State Environmental standards.

Consult your local Building Inspector or Fire Marshall before installation to determine the need to obtain a permit. Also inquire about restrictions and installation inspection requirements in your area.

If the stove is not installed properly, a home fire may result. To reduce the risk of fire, follow the installation instructions. Contact local building or fire officials about restrictions and installation inspection requirements in your area.

Not for use in a mobile home.

A floor plate of non-combustible material (tempered glass floor plates are acceptable) must cover under the stove and extend 16" (41 cm) (18" (45 cm) in Canada) in front of the stove door, 8" (20 cm) beyond the sides of the fuel-loading door, and under the pipe and 2" (5 cm) beyond each side for back venting. In Canada, the 8" (20 cm) floor protection is required beyond the sides of the stove and in the back of the stove (0" in the back for the US)

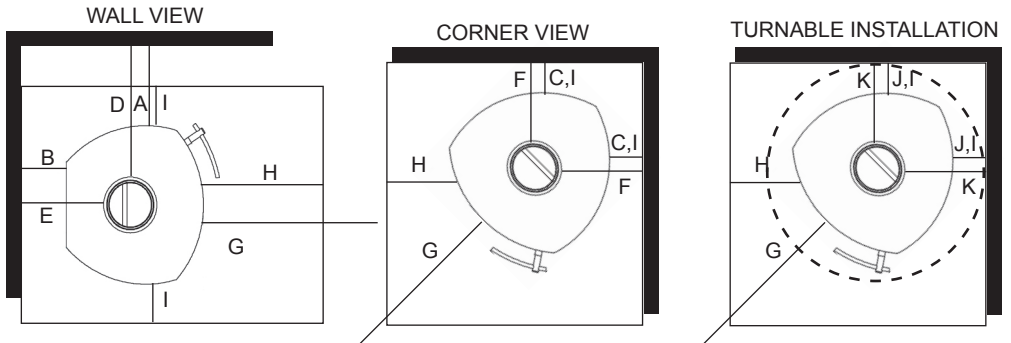

MINIMUM CLEARANCES TO COMBUSTIBLES

Description	Trendline 1-2-3 / Troja 1-2-3 / Softline / Zeus / Athene / Hera / Avanti / Finline 1-2 / Cosmo
A. DISTANCE TO SIDE WALL	US/CANADA 18" (46 cm)
B. DISTANCE TO BACK WALL	US/CANADA 10" (25 cm)
C. CORNER DISTANCE TO SIDE WALLS	US/CANADA 7" (18 cm)
D. CONNECTOR PIPE TO SIDE WALL	US/CANADA 26" (65 cm)
E. CONNECTOR PIPE TO BACK WALL	US/CANADA 16" (41 cm)
F. CORNER PIPE TO SIDE WALLS	US/CANADA 16" (41 cm)
G. DISTANCE TO FURNITURE	US/CANADA 36" (92 cm)
H. FRONT FLOOR PROTECTION	US 16" (41 cm) CANADA 18" (46 cm)
I. SIDE FLOOR PROTECTION	US 8" (20 cm) beyond the sides of the fuel loading door  CANADA 8" (20 cm) beyond the sides of the stove
J. DISTANCE TO WALL (TURNABLE)	US/CANADA 40" (100 cm)
K. CONNECTOR PIPE TO WALL (TURNABLE)	US/CANADA 48" (120 cm)
CEILING TO TOP OF STOVE	US/CANADA 36" (92 cm)
CEILING TO CONNECTOR PIPE	US/CANADA 18" (46 cm)

Note: A heat shield or protective wall may be used to reduce clearances if approved by the regulatory authority. Clearances to noncombustible materials are 2" (5cm), but note that "noncombustible" must be solid cement or block (not brick or tile over combustible material).

### Floor / foundation / wall

The stove must be installed/hanged on a non-combustible foundation/at a non-combustible wall - i.e. where a tile or brick floor is non-existing, the stove must meet the demands for the distance to combustible material under/above/beside the stove, according to applicable legislative requirements. Consult you dealer before installing the stove.

### Wall and corner models

If you have a Cubic Wall/Cubic Corner/Cubic W200 the stove must be installed with the enclosed furnishings and should meet the NFPA211 guidelines. The installation must not weaken the chimney construction. The anhorng must be done in consultation with your dealer/chimney sweep.

### Cubic 166/215

The tall models may reach the ceiling (or less than the 18" clearance). If the unit does not meet the proper clearance to the ceiling, the chimney pipe must be used to connect to the fire box.

#### MIMIMUM CLEARANCES TO COMBUSTIBLES

Description	Cubic 109/166/215/Wall/W200/Corner	
A. DISTANCE TO SIDE WALL	US/CANADA	18" (46 cm)
B. DISTANCE TO BACK WALL	US/CANADA	10" (25 cm)
C. CORNER DISTANCE TO SIDE WALLS	US/CANADA	7" (18 cm)
D. CONNECTOR PIPE TO SIDE WALL	US/CANADA	26" (65 cm)
E. CONNECTOR PIPE TO BACK WALL	US/CANADA	16" (41 cm)
F. CORNER PIPE TO SIDE WALLS	US/CANADA	16" (41 cm)
G. DISTANCE TO FURNITURE	US/CANADA	36" (92 cm)
H. FRONT FLOOR PROTECTION	US	16" (41 cm)
	CANADA	18" (46 cm)
I. SIDE FLOOR PROTECTION	US	8" (20 cm)
		beyond the sides of the fuel loading door
	CANADA	8" (20 cm)
		beyond the sides of the stove
J. DISTANCE TO WALL (TURNABLE)	US/CANADA	40" (100 cm)
K. CONNECTOR PIPE TO WALL (TURNABLE)	US/CANADA	48" (120 cm)
L. DISTANCE TO FLOOR	US/CANADA	20" (50 cm)
CEILING TO TOP OF STOVE	US/CANADA	36" (92 cm)

Note: A heat shield or protective wall may be used to reduce clearances if approved by the regulatory authority. Clearances to noncombustible materials are 2" (5cm), but note that "noncombustible" must be solid cement or block (not brick or tile over combustible material).

DIAGRAMS FOR CUBIC SERIES

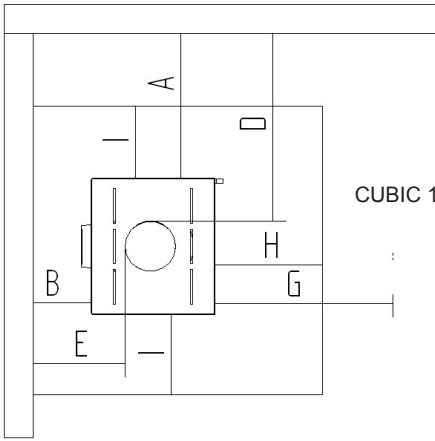

CUBIC 109/166/215

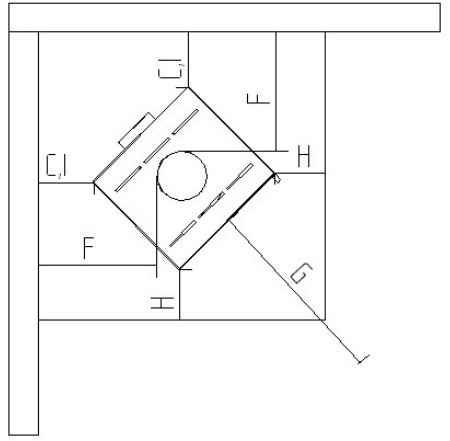

CUBIC WALL

CUBIC CORNER

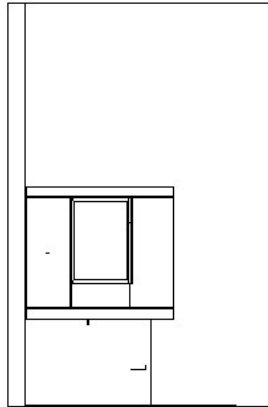
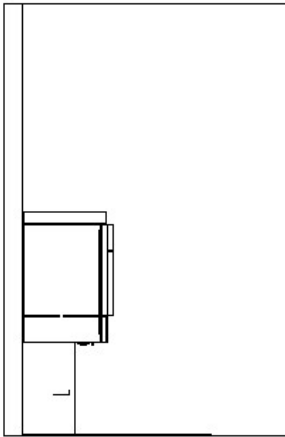

CUBIC WALL

CUBIC CORNER

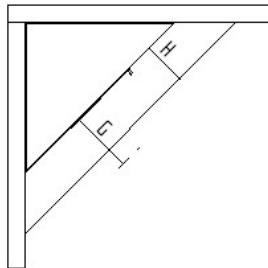
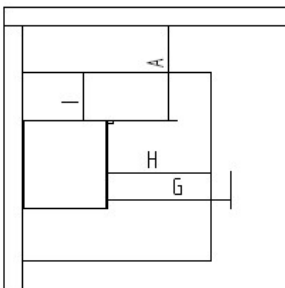

### Installation of Trendline 2 without the turntable feature

If the Trendline 2 stove is to be used without the turntable feature (screws still attached), please follow the standard installation procedures (page 5) under Wall View and Corner View for the correct clearances.

### Installation of Trendline 2 with the turntable

If the Trendline 2 is being used with the turntable feature, first remove the locking screws located under the stove's firebox (as shown below). This allows the stove to turn freely within its 90° range. Position and center the stove properly as described:

Turn the stove to the left most position. Measure and insure that all the standard required clearances are met in that position.

Turn the stove to the right most position. Measure and insure that all the standard required clearances are met in that position as well.

Make adjustments until all the clearances are met in both positions. These include stove, pipe, and floor plate clearances.

If placed in the center of a room (with a 360° turn range), remember that all clearances to combustible materials must be 36" for the Trendline 2.

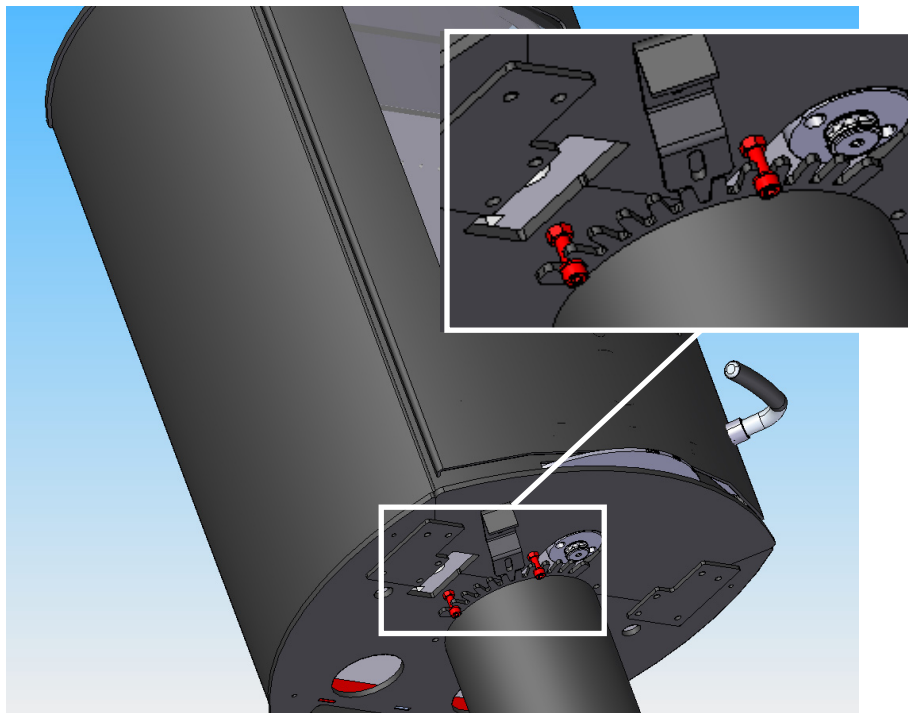

---

**IMPORTANT** - Failure to follow these instructions may result in property damage, bodily injury, or even death. You must follow the specific clearances for the turntable feature in order not to void the warranty and liability coverage.

---

### 3. Chimney

The Jydepejsen stoves must be installed using a Class A UL 103 HT approved factory-built chimney system or a code-approved masonry chimney with a flue liner. In Canada, the installation must conform to NFPA 211 or CAN/CSA-B365. The chimney must extend through the roof at least 3' (1 m), and 2' (6 m) above any structure within 10' (3 m). The condition of the chimney and height is very important. We suggest a total minimum height of 10' (3 m).

**Note!** Mount the special collar using the included hardware. When installing the first piece of pipe (at the stove), place the pipe over the collar (except on the Trendline 2 where the crimped end goes inside the collar!), which is designed so any moisture or creosote will drip back into the stove and burn away. If using a crimped pipe, trim or cut that section off at the bottom and place it over the collar. Install the remaining stovepipe segments with the crimped end down whenever possible. The hole in the casting is designed for any moisture to drip back into the stove.

#### Required Installation Components

- A. Chimney cap
- B. Insulated chimney
- C. Storm collar
- D. Roof flashing
- E. Ceiling support box or joist shield / firestop spacer
- F. Chimney connector pipe

### 4. Chimney connector

Aluminium and galvanized steel pipe is not acceptable for use with the Saturn woodstove. These materials cannot withstand the extreme temperatures of a wood fire and can give off toxic fumes when heated.

Do not use the connector pipe as a chimney.

Each chimney connector or chimney connector section must be installed to the stove flue collar and to each other with the male (crimped) end toward the stove.

**Chimney Connector**

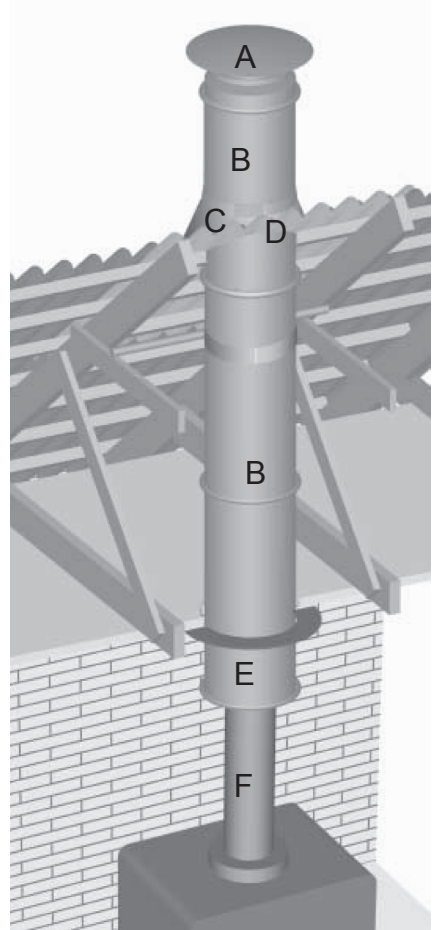
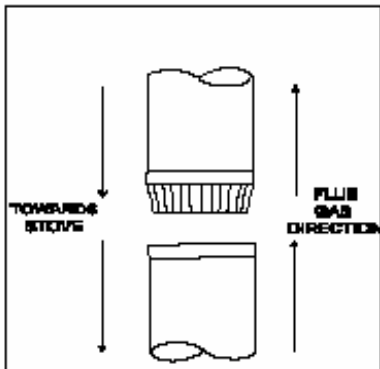

This prevents any amount of condensed or liquid creosote from running down the outside of the pipe or the stove top. All joints, including the flue collar connection must be secured with three sheet metal screws to ensure that the sections do not separate.

For the best performance the chimney connector should be as short and direct as possible, with no more than two 90° elbows. The maximum horizontal run is 36" and a recommended total length of chimney connector should not exceed 10 feet. Always slope horizontal runs upward ¼" per foot toward the chimney. Note the chimney connector pipe should not pass through an attic or roof space, closet or similar concealed space, or a floor or ceiling.

**DO NOT CONNECT THIS STOVE TO A CHIMNEY FLUE OR AIR DISTRIBUTION DUCT OR ANY SYSTEM SERVING ANOTHER APPLIANCE.**

For venting vertically into a Class A chimney, single wall pipe (at least 24 gauge) may be used in the room where the stove is installed. Refer to the manufacturer's instructions for the connection to the listed chimney. The chimney / chimney connector must not be smaller than 6" (15 cm) in diameter. For venting directly into a masonry chimney or through a thimble, the top of the single wall pipe must be at least 18" (46 cm) below a combustible ceiling and conform to NFPA 211 or CAN/CSA-B365 guidelines and methods. See diagram below.

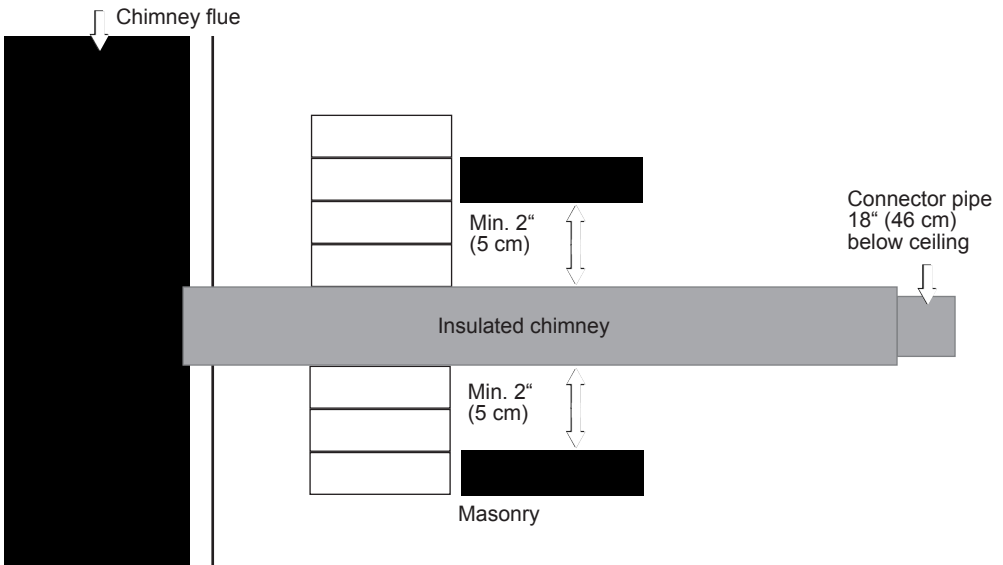

For rear venting or other not listed configurations, consult the local building codes and follow the NFPA 211 or CAN/CSA-B365 guidelines. If the chimney connector is fitted with a baffle, it must be manually operated, visibly placed for ease of use, and must not close completely. Consult your chimney expert if you have any questions.

Make sure that there is easy access to the chimney cleanout door.



Read the instructions on page 8 carefully before connecting: "Chimney Connector Systems and Clearances from Combustible Walls for Residential Heating Appliances".

# Chimney Connector Systems and Clearances from Combustible Walls for Residential Heating Appliances

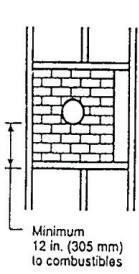

Minimum chimney clearance to brick and combustibles 2 in. (51 mm)

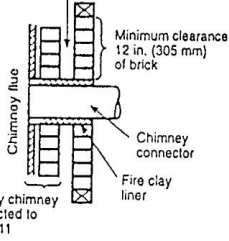

A Minimum 3.5-in thick brick masonry all framed into combustible wall with a minimum of 12-in brick separation from clay liner to combustibles. The fireclay liner shall run from outer surface of brick wall to, but not beyond, the inner surface of chimney flue liner and shall be firmly cemented in place.

Minimum chimney clearance from masonry to sheet steel supports and combustibles 2 in. (51 mm)

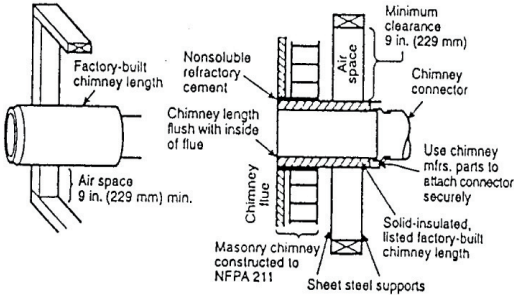

B Solid-insulated, listed factory-built chimney length of the same inside diameter as the chimney connector and having 1-in. or more of insulation with a minimum 9-in. air space between the outer wall of the chimney length and combustibles.

Minimum chimney clearance to sheet steel supports and combustibles 2 in. (51 mm)

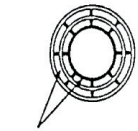

Two ventilated air channels each 1 in. (25.4 mm). Construction of sheet steel.

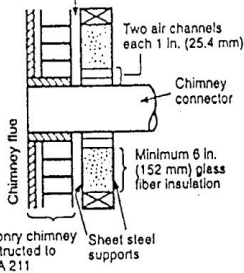

C Sheet steel chimney connector, minimum 24 gauge in thickness, with a ventilated thimble, minimum 24 gauge in thickness, having two 1-in. air channels, separated from combustibles by a minimum of 6-in. of glass fiber insulation. Opening shall be covered, and thimble supported with a sheet steel support, minimum 24 gauge in thickness.

Minimum chimney clearance to sheet steel supports and combustibles 2 in. (51 mm)

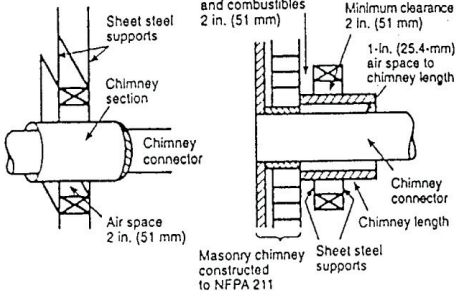

D Solid insulated, listed factory-built chimney length with an inside diameter 2-in. larger than the chimney connector and having 1-in. or more of insulation, serving as a pass-through for a single wall sheet steel chimney connector of minimum 24 gauge thickness, with a minimum 2-in. air space between the outer wall of chimney section and combustibles. Minimum length of chimney section shall be 12-in. chimney section spaced 1-in. away from connector using sheet steel support plates on both ends of chimney section. Opening shall be covered, and chimney section supported on both sides with sheet steel supports securely fastened to wall surfaces of minimum 24 gauge thickness. Fasteners used to secure chimney section shall not penetrate chimney flue liner.

Before installation, it is also important to check that the Vermiculite panels are correctly fitted in the combustion chamber.

The wood holder in the combustion chamber is not to be removed.

On some baffle plates you will find a metal band. This band is mounted for transport protection only, and should be removed.

## 5. Heat generation and distribution

All Jydepejsen wood-burning stoves are two stoves in one. Inside is the actual stove, produced from strong steel plates, and on the outside a covering of steel, ceramic tiles or soapstone. There are two major types of heat: radiant heat and convection heat. In the airspace between the actual stove and the covering, convection heat is generated. The air is drawn in at the bottom of the firebox. The heated air then flows upwards and begins to circulate throughout the room, subsequently dispersing into the neighboring rooms, providing perfect heat distribution. So the question of where to position your stove is an important one. The ideal location is fairly central, in the room where you require most heat.

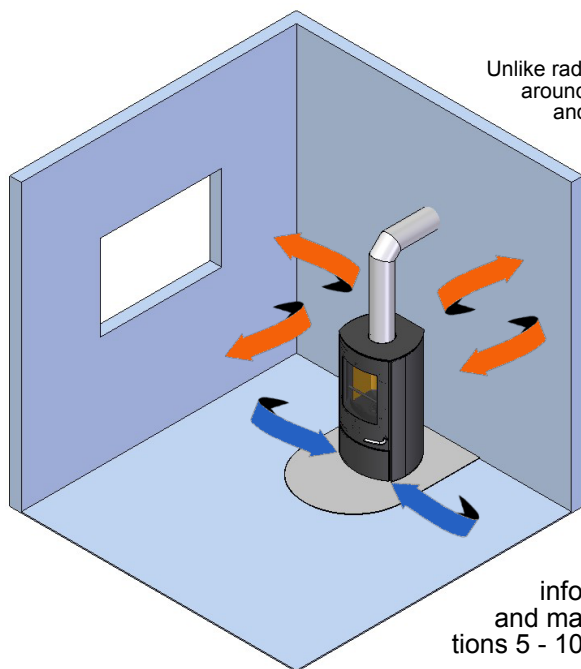

Unlike radiant heat, which is highly concentrated around the stove, convection heat flows upwards and spreads to neighboring rooms.

It is very important to ensure that your chimney has a good draft. Your dealer or your chimney sweep will be able to guide and advise you on your chimney conditions.

Follow the operating instructions and use seasoned wood, which burns easier and cleaner in the combustion chamber, until a proper draft is obtained. For further information on using wood and lighting and managing the fire, please refer to sections 5 - 10.

Please note that the stove paint will harden during the first few initial fires. This means that the stove will generate smoke and an odor of paint, which will dissipate after about 1 hour's operation. It is a good idea to ensure effective ventilation during this phase. Also, avoid touching the stove during the curing process.

The stove will expand and contract during the lighting and cooling phase, possibly resulting in creaking noises. This phenomenon is completely normal for steel stoves.

## 6. Sensible wood burning

When dry wood is burned in a wood-burning stove the following process occurs (over a period of approx. 1 hour):

- After lighting the log starts to dry and heats up.
- After drying the temperature of the wood rises to approx. 300–400° F (150 - 200° C) and is converted into volatile gases and charcoal.
- As the wood is gasified a certain portion of the gases produced burn and are converted into carbon dioxide and water. During this phase the temperature rises to around 1100 - 1500° F (600 - 800° C) and a plentiful supply of air is required. If the air supply is accidentally reduced, the flames will be smothered, but this will not stop the conversion of the wood into gas. The unburned gas will then flow out into the chimney, causing a nuisance outdoors and build up of creosote.
- Next the charcoal will burn, which requires very little air supply. Finally, new wood must be laid on the glowing charcoal cinders.



### Warning

It is extremely important to ensure that you do not overheat your stove, as this can cause irreparable damage. This kind of damage is not covered by the warranty. Extremely high combustion temperatures can occur when using inappropriate fuel, such as kiln-dried wood, coal, pressure-treated wood, scrap wood. NEVER USE GASOLINE, GASOLINE-TYPE LANTERN FUEL, KEROSENE, CHARCOAL LIGHTER FLUID, OR SIMILAR LIQUIDS TO START OR 'FRESHEN UP' A FIRE IN THIS HEATER. KEEP ALL SUCH LIQUIDS WELL AWAY FROM THE HEATER WHILE IT IS IN USE.

HOT WHILE IN OPERATION. KEEP CHILDREN, CLOTHING AND FURNITURE AWAY. CONTACT MAY CAUSE SKIN BURNS

DO NOT STORE SOLID FUEL WITHIN SPACE HEATER INSTALLATION CLEARANCES OR WITHIN THE SPACE REQUIRED FOR CHARGING AND ASH REMOVAL.

### Incorrect wood burning

Too much air supplied to the combustion process causes an uncontrollable fire that will heat the entire stove very rapidly to an extremely high temperature. This can happen if you fire with conditions that produce an extra-strong draft in the chimney. Never fill the stove completely with wood. It is better to heat a stove up slowly. This will prevent cracked tiles/soapstone, damage to welds and annealing of the iron. Overfilling the firebox also substantially reduces the useful life of the vermiculite panels, as cracks are more easily caused. The log size should be about 2" (5 cm) less than the width of the firebox. Start slowly with a "normal" fire from the bottom, and slowly build it up to a maximum of three logs.

## 7. Technical information on wood burning

1 kilo of dry wood is made up of 20% water, with the remaining 80% divided into 60% gas and 20% charcoal. The 60% gas only contains around half the energy content of the wood, while the 20% charcoal contains the other half. To achieve optimum combustion, the temperature must reach 1100 - 1500° F (600 - 800° C). Reload with a few pieces of wood at a time. If too much wood is placed on a layer of embers, the air supplied will not be sufficient to attain the required temperature, and the gases will disappear out through the chimney unburned. It is vital to supply air to the fire immediately after adding fuel, so there are flames in the firebox, and the gases burn. (Refer to the Refueling section 9 for further guidance).

Remember that three logs will burn just as quickly as one.

The quantity of firewood determines the heat emission - the more heat you require, the more wood you should add at each refueling.

Types of fuel and heating values

All the stoves are constructed and approved for burning wood.

Combustion involves conversion of the fuel from solid form into gases, water vapor and charcoal. The heating value is an expression of the content of combustible gases - stated in kcal/kg. All wood has roughly the same heating value per kilogram. The lighter the wood, the more that must be used to achieve the same heating value as with a heavier species of wood.

Type of wood	Dry wood - Lbs./ft3 (Kg/m3)	Compare to beech
Beech and oak	36.2 (580)	100%
Ash	35.6 (570)	98%
Maple	33.7 (540)	93%
Birch	31.8 (510)	88%
Mountain pine	30.0 (480)	83%
Fir	24.3 (390)	67%
Poplar	23.7 (380)	65%

As mentioned, air-dried wood contains around 20% water, corresponding to a heating value of approx. 4 kWh/kg equivalent to approx. 3440 kcal/kg (1kW = 860 kcal.)

Warning!



NEVER burn impregnated wood, painted wood, laminated plastic, plywood, chipboard, refuse, milk cartons, printed matter or similar. Use of such materials will invalidate your warranty, as this may emit toxic, corrosive and hazardous fumes when burned. They may also cause a build-up of the toxic gas dioxin, which is damaging to

the stove and the environment.



Fuel

Recently-felled wood contains 60-70% water and must therefore be seasoned before it can be used in a wood-burning stove. It must be cut, split and air dried, and must contain no more than approx. 25% water before use. This equates to the wood being left in the open for approx. 1 year - covered only to protect against rain.

It is very important to always use pure, dry wood. Damp wood requires a lot of air for combustion, as extra energy in the form of heat is needed to dry it out. Heat emission is therefore minimal. When wood is burned slowly, it produces tar and other organic vapors, which combine with expelled moisture to form creosote. The creosote vapors condense in the relatively cool chimney flue of a slow-burning fire. As a result, creosote residue accumulates on the flue lining. When ignited, this creosote makes an extremely hot fire.

The chimney and chimney connector should be inspected at least once every two months during the heating season to determine if a creosote buildup has occurred. If creosote has accumulated, it should be removed to reduce the risk of a chimney fire.



## 8. Air supply and combustion

### Preheated air

The stove utilizes a combustion technology involving preheated air. The air supply for the combustion process comes from an air inlet and is then conducted through ducts in the stove that become warm when the stove is in use. The advantage of this technology is that the air is already warm when it enters the firebox, so a high combustion temperature can be attained very rapidly.

### Startup and primary air supply

Most of the stoves are designed with both a startup and primary air vent. The startup air vent supplies a very direct volume of air, which only serves a purpose in the lighting phase. The startup air supply should therefore only be used when lighting the stove. The primary air vent, however, is used for air control once the stove is lit.

Startup air is defined as combustion air for burning the “mass of wood” and stimulates production of volatile gases.

Primary air is used to burn off the gases at high temperatures (above 1,000° Fahrenheit (540° C)) and to keep the glass free of soot.

For wood to burn correctly, the right amount of air has to be supplied at the right time and place.

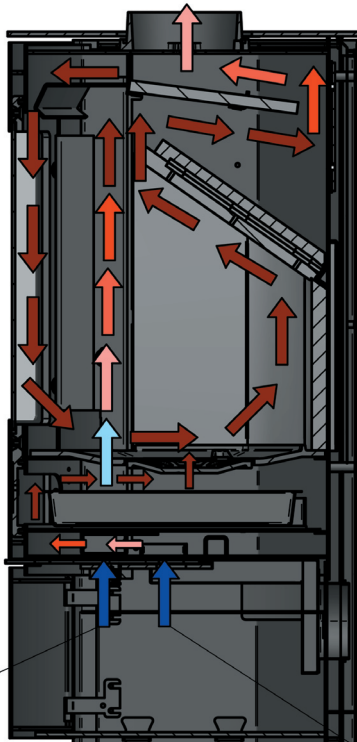

Primary air

Startup air

In the Jydepejsen DuplicAir system, the startup and primary air are combined into one air supply system.



Air circulation when stoking

There are two other non-adjustable air systems on the stove; secondary air and direct air.

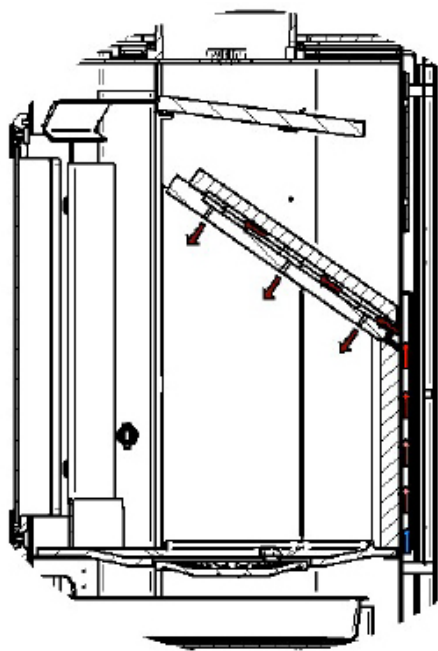

#### Secondary air:

To ensure a better combustion of gases, the stove is constructed with secondary air holes in the baffle plates. Preheated air is supplied through these holes, which ensures burning of the last amount of gases before they slip out through the chimney, even if the primary air has been shut down.

Secondary air flow

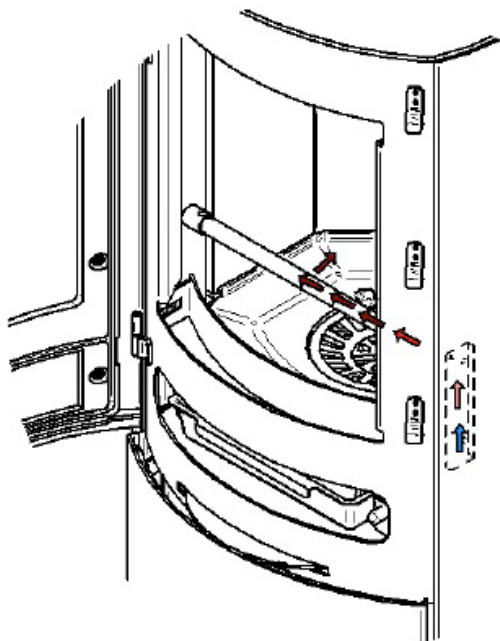

#### Direct air:

Direct air contributes to a cleaner and more efficient combustion at lower temperatures.

Preheated air is supplied directly into the fire and makes sure that the bed of embers do not die out.

Direct air flow

## 9. preparation for the first fire

Once your stove is installed and all instructions have been read, the first fire can be started. However, please take careful note of the following:

The baking liner should be removed before the initial lighting. A sudden temperature change could cause it to crack. Tiles and soapstone are not covered by the warranty, so ensure that they are at least at room temperature before lighting up the stove.

The baffle plate and vermiculite panels may crack under hard impact. These are not covered by the warranty, so avoid tossing the wood in the firebox.

Avoid touching the stove during initial fires, as the paint is hardening at this stage. Otherwise this may cause scratches in the paint.

It is a good idea to ensure effective ventilation during the first firing, as the stove will generate smoke and an odor of paint. The smoke and paint odor will dissipate after about 1 hour's operation and is not hazardous to health.

Do not use grate or elevate Fire – build wood fire directly on hearth.

## 10. Lighting the stove

1. Turn the air wheel to the maximum (startup air)
2. Add crumbled paper / firelighters and kindling wood to the bottom of the fire box (combustion chamber).
3. The kindling (about 3 lbs or 1.5 kg) is to be built up crosswise.
4. Light the fire.
5. The door should be ajar for a couple of minutes during the lighting phase.
6. The air wheel must be adjusted down after approx. 10 minutes (primary air); how much depends on the chimney draft - however, the air supply must be diminished to the point where you obtain steady and calm flames.



Once there is a good bed of embers in the stove, you can add wood. It is important not to open the door while there are flames in the stove, as this may cause smoke to flow out into the room. Add wood on the basis of your heating requirements. However, never add more than 4.4 lbs or 2 kg of wood every 1.5–2 hours. Please remember that the exterior surfaces especially the top and front of the stove in particular will become very hot during burning.

## 11. Refueling

1. Turn the air wheel to the maximum.
2. To minimize the back draft, the door should be ajar for about one minute before you open it completely.
3. Open the door slowly.
4. Add 2 – 3 pieces of firewood to the combustion chamber.
5. Close the door.
6. Turn down the air supply when the fire has caught the wood, to obtain steady and calm flames.

## 12. Troubleshooting

Combustion problems can arise if the combustion conditions are not optimal. This can be corrected by following the advice given below.

Problem	Explanation	Remedy
<b>Insufficient draft</b>	<ul style="list-style-type: none"> <li>▪ The flue vent is closed.</li> <li>▪ The access hatch in the chimney is defective or missing.</li> <li>▪ The chimney is blocked by a bird's nest or similar.</li> <li>▪ The flue pipe is sooted up, or there is an accumulation of soot on top of the baffle plate.</li> <li>▪ The chimney is too small.</li> <li>▪ The baffle plate may be positioned incorrectly.</li> <li>▪ Negative pressure in the house.</li> </ul>	<ul style="list-style-type: none"> <li>▪ Open the flue vent.</li> <li>▪ Contact your chimney sweep/stove dealer for further advice, or clean the flue pipe and firebox.</li> <li>▪ Check the fitting of the baffle plate – see the operating instructions.</li> <li>▪ In well-insulated buildings negative pressure can occur – increase the air supply to the room.</li> </ul>
<b>Too much draft</b>	<ul style="list-style-type: none"> <li>▪ The baffle plate may be positioned incorrectly.</li> <li>▪ If using kiln-dried wood, this requires less air than normal wood.</li> <li>▪ The air vent is constantly wide open.</li> <li>▪ The sealing strips on the door are worn and pressed completely flat.</li> <li>▪ The chimney is too large.</li> </ul>	<ul style="list-style-type: none"> <li>▪ Check the fitting of the baffle plate – see the operating instructions.</li> <li>▪ Reduce the air supply.</li> <li>▪ Check the sealing strips. If these are worn, replace them as described in the operating instructions.</li> <li>▪ Contact your chimney sweep/stove dealer for further advice.</li> </ul>
<b>The glass pane is soot-ing up</b>	<ul style="list-style-type: none"> <li>▪ The wood is too wet.</li> <li>▪ The air vent is not sufficiently open.</li> </ul>	<ul style="list-style-type: none"> <li>▪ Dry wood with a maximum of 20% moisture should be used.</li> <li>▪ The air vent must be opened to supply more air for combustion.</li> </ul>
Clouded glass or with white film	<ul style="list-style-type: none"> <li>▪ Poor combustion (too low temperature in the stove).</li> <li>▪ Incorrect combustion (burning waste wood, painted wood, impregnated wood, laminated plastic, plywood or similar.)</li> </ul>	<ul style="list-style-type: none"> <li>▪ Follow the instructions for correct burning as specified in this manual.</li> <li>▪ Ensure that you use pure, dry wood in your stove.</li> </ul>
<b>Smoke comes out into the room when the door is opened</b>	<ul style="list-style-type: none"> <li>▪ Pressure compensation is occurring in the firebox.</li> <li>▪ The chimney is not a suitable size for the firebox.</li> </ul>	<ul style="list-style-type: none"> <li>▪ Open the air vent wide for about 1 min. before opening the door - avoid opening the door rapidly.</li> <li>▪ Check the height of the chimney. It may be too short for the minimum draught required from the chimney.</li> </ul>
<b>White smoke</b>	<ul style="list-style-type: none"> <li>▪ The combustion temperature is too low.</li> <li>▪ The wood is too damp and contains water vapor.</li> </ul>	<ul style="list-style-type: none"> <li>▪ Increase the air supply.</li> <li>▪ Always ensure that you use pure, dry wood in your stove.</li> </ul>
<b>Black or greyish black smoke</b>	<ul style="list-style-type: none"> <li>▪ Incomplete combustion.</li> </ul>	<ul style="list-style-type: none"> <li>▪ Increase the air supply.</li> </ul>



Lighting and burning problems are usually due to wet wood or insufficient draft.

### **13. Maintenance of the stove**

Gaskets and vermiculite panels need to be replaced. How often depends on how much you use your stove. In some cases every year, others every second or third year. Generally, the gaskets need replacing when it is flattened, and the door no longer fits tightly against the front of the stove. A new set of gaskets with glue can be purchased from your local dealer.

Vermiculite panels must be replaced when they are worn thin, or when possible cracks are so wide that you can actually see steel through them. If the panels are not replaced on such occasions, they lose their power of insulation and heat reflection.

Movable and mechanical parts should be greased once a year with a heat-resisting lubricant (closing mechanisms, hinges etc).

#### Door

Inspect the seals on the door and ashpan front, and replace if they will not close tightly. If the glass pane is dirty, clean it gently with a warm wet cloth and a little mild detergent, dipped in ash. Check that the seam between glass panel and door is completely airtight. If necessary, tighten any screws holding the inner frame in place - but not too hard, as it could crack the glass.

If the glass is still loose, replace the gasket.

#### Disposal of ashes

Ashes should be placed in a metal container with a tight fitting lid. The closed container of ashes should be placed on a noncombustible floor or on the ground, well away from all combustible materials, pending final disposal. If the ashes are disposed of by burial in soil or otherwise locally dispersed, they should be retained in the closed container until all cinders have thoroughly cooled.

#### Vermiculite

The heat-reflecting and insulating panels in the firebox of all wood-burning stoves from Jydepejsen are made of vermiculite. This material in its basic form consists of laminated minerals, and is supplied by an ISO 9001 certified company. Vermiculite poses no health hazards. It offers various benefits in terms of heat reflection, insulation and utilization, thereby helping to provide Jydepejsen stoves with an even higher combustion temperature, improved degassing of the wood and, consequently, greater efficiency in the stove.

If the vermiculite panels are very worn (less than half thickness), new ones should be ordered. Contact your dealer, who will be happy to assist you. You can check page 17 to see how the panels are fitted in the stove.

#### Cleaning guide

A wood-burning stove should be thoroughly inspected and cleaned at least once during the course of the heating season. Check the stove only when it is cold.

Before sweeping of your stove, the baffle plates should be removed. This will allow loose soot from the chimney to drop into the firebox. See page 17 - instructions on how to change the vermiculite panels.

The air control should be closed to prevent soot and ash spilling into the room.

After sweeping, clean any soot and ash from the vermiculite holders in the firebox. The baffle plates can then be put back in place.

If creosote has accumulated, it should be removed to reduce the risk of a chimney fire.

## Ash

All wood-burning stoves from Jydepejsen have a large ashpan. Empty it before it fills completely, and do not allow the ash to collect in a cone under the shaker grate. Ash is an excellent insulator, and so the temperature of the grate can get very hot, and the grate could be damaged.

## External maintenance

Maintenance of Jydepejsen wood-burning stoves is pretty much the same as for the rest of your furniture: use a cloth and mild soapy water without solvents. After cleaning, wipe the stove with a dry cloth. The stove can be carefully repainted, as necessary, using Senotherm 12-1644 aerosol paint in either black or grey, as appropriate for your particular stove. This paint can be purchased from your stove dealer.

## *Ceramic tiles and soapstone*

### The finished ceramic tile

Dimensional accuracy and colorfastness are trade requirements and demonstrate the quality level of the tile manufacturer. With natural raw materials, variations and shading may occur or small fine glazing cracks and clouding may form. Modern technology ensures that such reactions in the surface structure do not affect the quality of the finished tile. These textures in the surface are therefore not flaws, but rather a mark of the craftsmanlike individuality.

If you discover any visible cracks in your ceramic tiles on unpacking, please contact your dealer immediately.

### Cleaning ceramic tiles

Ceramic from Jydepejsen is simple to maintain. Wiping the tiles with a damp cloth is generally adequate. For more stubborn marks, use a little mild soapy water. Like other natural products, ceramic tiles cannot tolerate strong acids or leaching solutions. So, avoid strong detergents. With correct and careful maintenance your ceramic tiles will radiate heat and character for many years to come.

### Production of soapstone

Manufacturing the large soapstone blocks is a very expensive process. The preparation involves rough and fine cutting, shaping and bevelling, regular quality control, final inspection of each soapstone tile and selection of sets of soapstone tiles. Dimensional accuracy is required, but soapstone is a natural product, and shading will certainly occur. This is a mark of nature's own unique design.

If you discover any visible cracks in your soapstone tiles on unpacking, please contact your dealer immediately.

### Cleaning soapstone

Soapstone is very simple to clean. Wiping the soapstone with a damp well-squeezed cloth soaked in lukewarm water is generally sufficient. Avoid all types of detergent. Any minor scratches can be carefully removed using very fine sandpaper. Should any of your soapstone tiles need repairing, please contact your dealer.

If soapstone is heated to more than 932° F (500° C), brownish blotches will appear on it. Should this occur, it is a question of the soapstone having been overheated, which is not covered by the warranty. With correct maintenance the soapstone cladding on your stove will retain its beautiful and individual character for many years to come.

### Replacing door gaskets (except the Cubic series)

1. Remove the gasket from the inner frame and clean the band mark (it is not necessary to remove the door from the stove).
2. Add a band of heat-resistant glue on the band mark.
3. Push new gasket down into the mark.
4. Close the door and let the glue harden for about 24 hours, before you open the door again. If you do not let the glue harden sufficiently before you open the door, the gasket may fall out.

### Replacing the gasket at the glass (except the Cubic series)

1. Lift the door from the hinges and place it on a flat base.
2. Dismount bolts / screws from the inner frame.
3. Dismount the bolt and the ratchet that hold the handle.
4. Lift off the inner frame.
5. Remove the old gasket from the glass.
6. Add new gasket to the glass.

*Remounting of the glass takes place in the opposite order.*

### Replacing door gaskets - Cubic series

1. Remove the gasket from the inner frame
2. Push new gasket down into the groove.

### Replacing the gasket at the glass - Cubic series

1. Lift the door from the hinges and place it on a flat base.
2. Dismount bolts and screws from the closing system.
3. Dismount 2 screws at the bottom and 2 screws at the top.
4. Lift off the inner frame.
5. Remove the old gasket from the glass.
6. Add new gasket to the glass.

*Remounting of the glass takes place in the opposite order.*

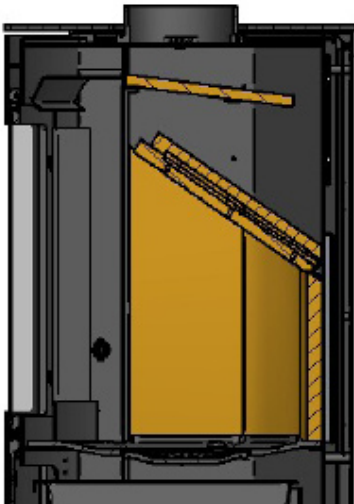

### Change of the vermiculite panels

1. Lift up and turn the lower baffle plate a little, pull it down along the side panels and out through the door.
2. Remove the two side panels in the front.
3. Remove the two side panels in the back.
4. Now you can remove the upper baffle plate.

## 14. Warranty

Brand-new wood-burning stoves from Jydepejsen A/S come with a 5-year warranty. The warranty covers defects in materials or workmanship.

Any claims during the warranty period should be directed to the dealer who sold the stove. All stoves from Jydepejsen come with their own individual serial number on the type plate on the back of the stove. Please quote stove model and serial number to your dealer in connection with service tasks.

In the event of warranty repairs, a signed and dated invoice must also be produced, showing the dealer's name. The warranty does not cover dismantling, transport and reassembly of your stove.

### No compensation will be granted for:

- Damage during transport
- Damage to other articles resulting from use of the stove
- Damage arising from misuse, such as overheating – avoid this by reading the operating instructions carefully
- The directions in the operating instructions have not been followed.

Normal wear and tear parts such as vermiculite panels, baffle plates and gaskets are not covered by the warranty. Furthermore, glass, ceramic tiles and soapstone are not covered by the warranty. If any of the above mentioned need replacing, new parts can be ordered from your dealer.

## 15. Spare parts list (except the Cubic series)

Article No.	Article description	Dimensions H x B x D
44101125-0	Vermiculite side panel, right	
44101130-0	Vermiculite side panel, left	
44101120-0	Vermiculite side panel, left, beveled	
44101115-0	Vermiculite side panel, right, beveled	
44101110-0	Vermiculite rear panel	
44101100-0	Vermiculite set	
44101070-0	Vermiculite baffle plate, upper	
44101135-0	Vermiculite baffle plate, lower	
56700020	Glass Cosmo serie	489 x 340 x 4 mm
44001600	Glass	400 x 336 x 4 mm
55015150	Cast-iron bottom	Thickness: 9 mm
55000100	Shaker grate	
55104140	Ash pan	Capacity: 3.5 l
44300120	Gasket set with glue	Ø 9 mm
4490000-0	Direct air kit	

## Cubic series

44101125-0	Vermiculite side panel, right	
44101130-0	Vermiculite side panel, left	
44101120-0	Vermiculite side panel, left, beveled	
44101115-0	Vermiculite side panel, right, beveled	
56100116	Vermiculite front panel	
44101110-0	Vermiculite rear panel	
44101070-0	Vermiculite baffle plate, upper	
44101135-0	Vermiculite baffle plate, lower	
56100039	Glass	469 x 458 x 4 mm
56100200	Cast-iron bottom	Thickness: 9 mm
55000100	Shaker grate	
55104140	Ash pan	Capacity: 3.5 l
44300070	Gasket	20 x 7 mm
4490000-0	Direct air kit	

## Cubic series - assembly

### Cubic Wall :

The stove must be prepared for either top- or rear outlet. Standard construction is rear outlet. Fasten the furnishing on the wall. Place the stove on the lower hooks on the furnishing, tip up the stove and fasten it.

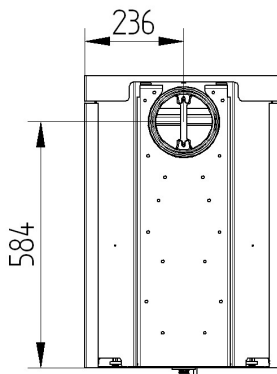
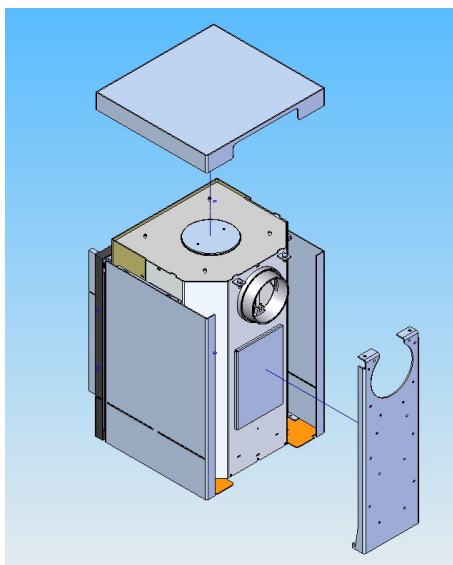

*Back side of stove*

### Cubic Corner :

The stove must be prepared for either top- or rear outlet. Standard construction is rear outlet. Fasten the furnishing on the wall. Place the stove on the lower hooks on the furnishing, tip up the stove and fasten it.

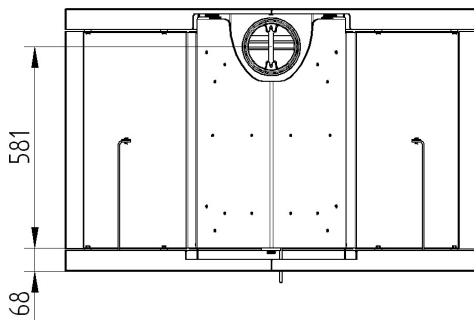
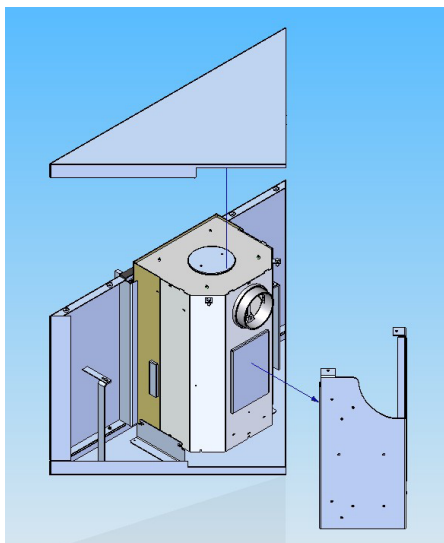

*Back side of stove*

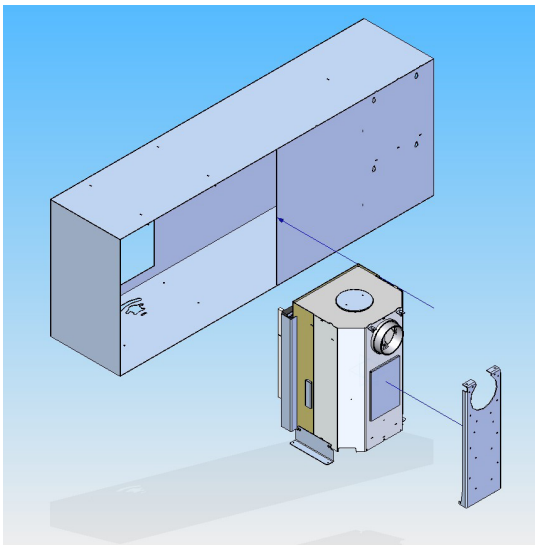

**Cubic W200 :**

The stove must be prepared for either top- or rear outlet. Standard construction is rear outlet.

Fasten the furnishing on the wall.

Place the stove on the lower hooks on the furnishing, tip up the stove and fasten it.

Assemble the stove by pushing the steel cladding in and over the stove.

Fasten the cladding to the wall by using 4 screws - screw holes are located in the fire box. Repeat the procedure for the bottom plate.

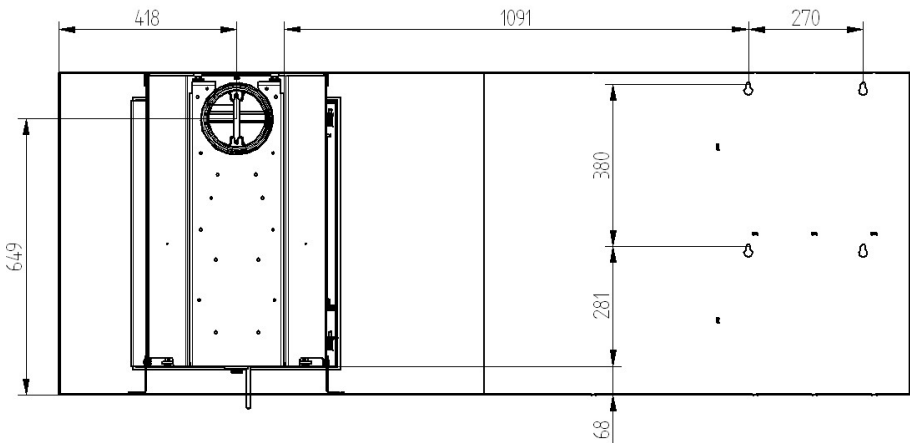

*Back side of stove*

**Cubic 109 :**

The stove is available with top- or rear outlet. Standard construction is top outlet. Adjusting is possible by using the 4 adjusting screws in the wood compartment.

**Cubic 166 :**

The stove is available with top- or rear outlet. Standard construction is top outlet. Adjusting is possible by using the 4 adjusting screws in the wood compartment.

**Cubic 215 :**

The stove is available with top- or rear outlet. Standard construction is top outlet. Adjusting is possible by using the 4 adjusting screws in the wood compartment.

Trendline soapstone - convection

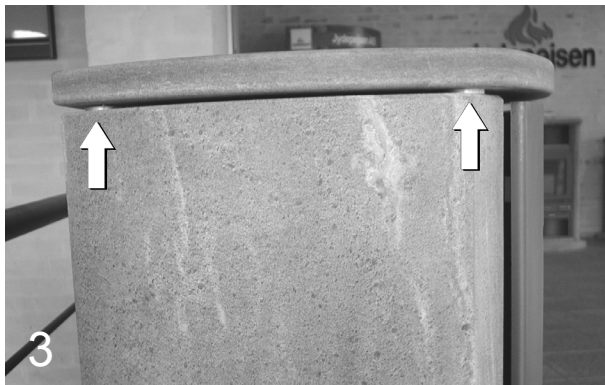

Trend-line with full soapstone cladding  
Soapstone assembling

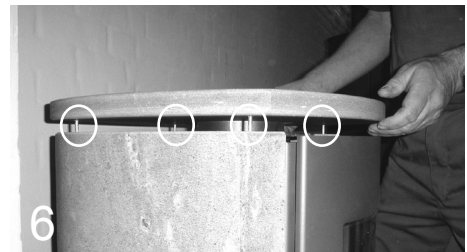
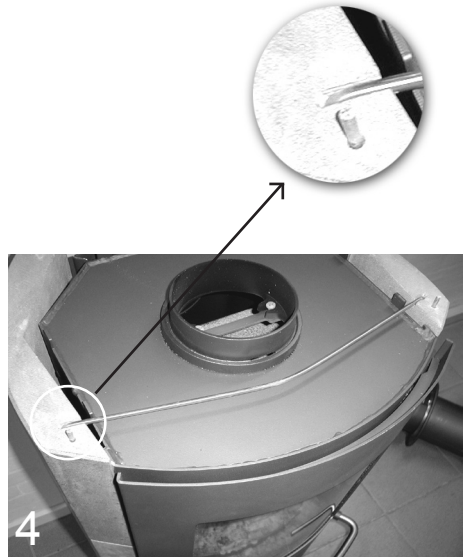
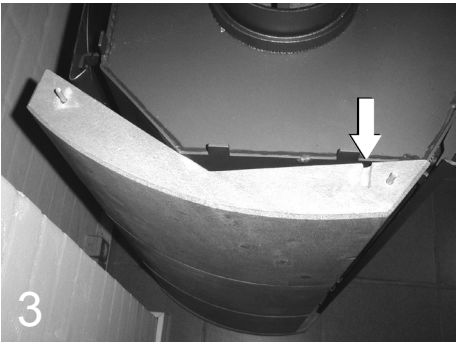

Softline with full soapstone or ceramic cladding  
Soapstone assembling

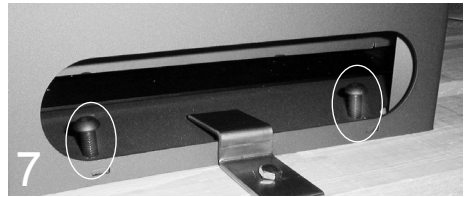
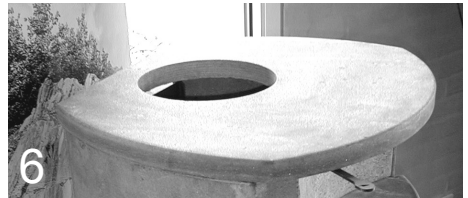
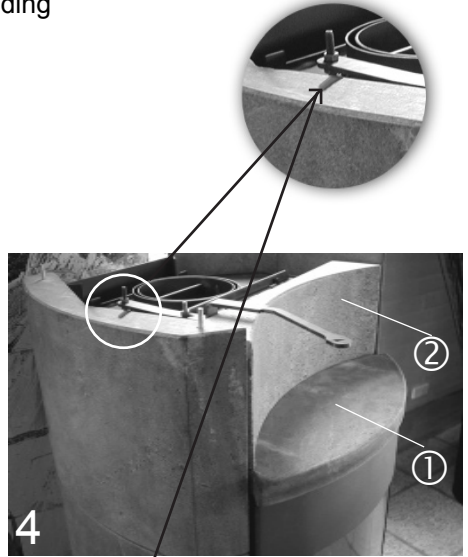
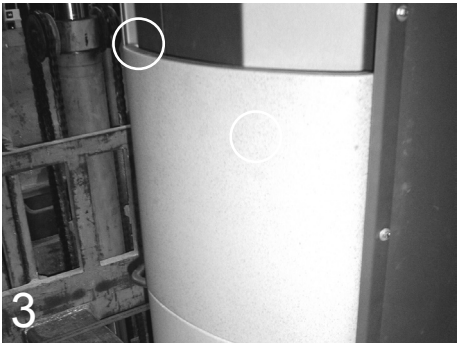
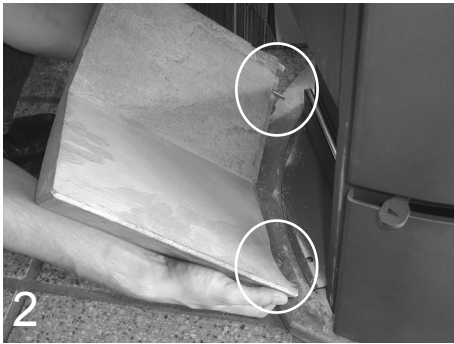

Softline with full soapstone or ceramic cladding  
Ceramic assembling

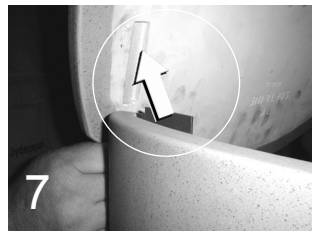
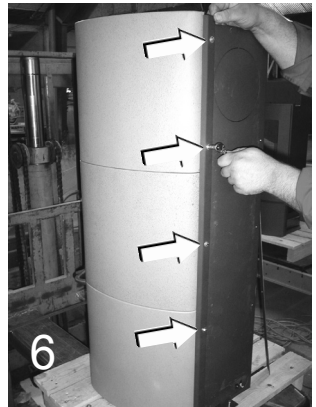
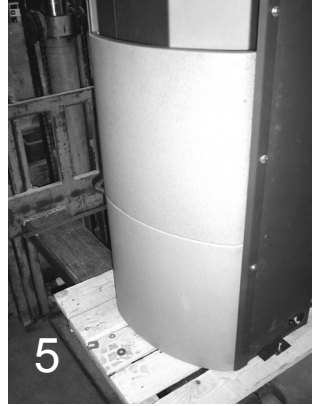
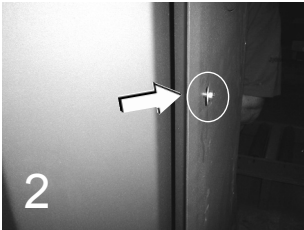

Manufactured by:

  
**Jydepejsen**<sup>®</sup>

Ahomsvinget 3-7 . DK-7500 Holstebro  
T.++45 96101200 F.++45 97425216 . [www.jydepejsen.com](http://www.jydepejsen.com)

Imported by:

  
**WITTUS**  
FIRE BY DESIGN

PO Box 120 . Pound Ridge NY  
T.914-764-5679 . F.914-764-0465 . [www.wittus.com](http://www.wittus.com)